

APPENDIX D
Proposed Layout Plan

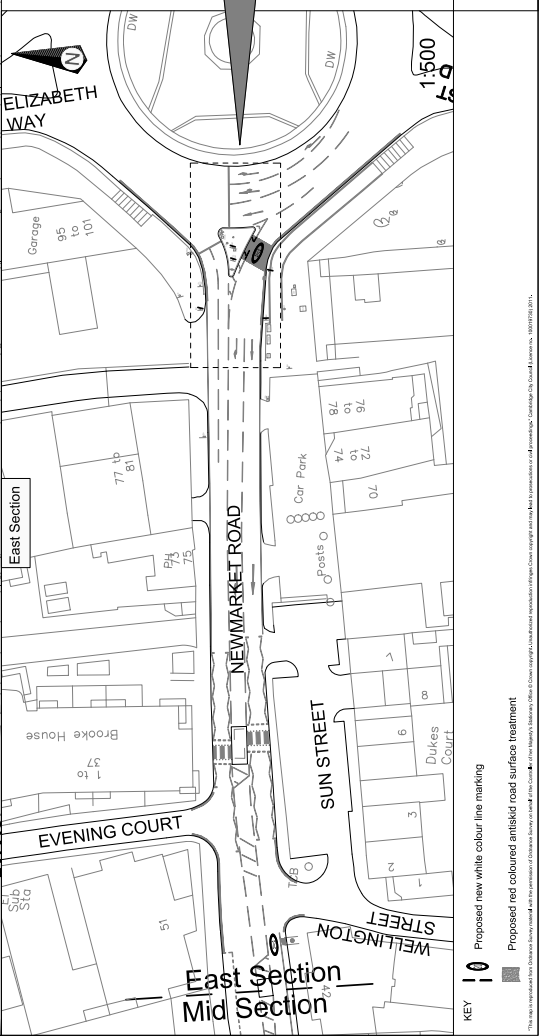
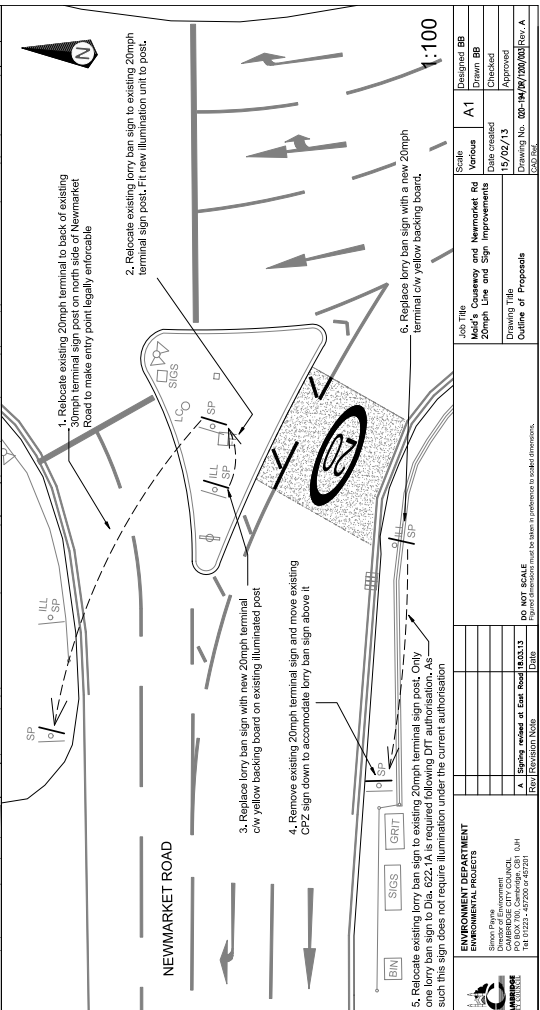
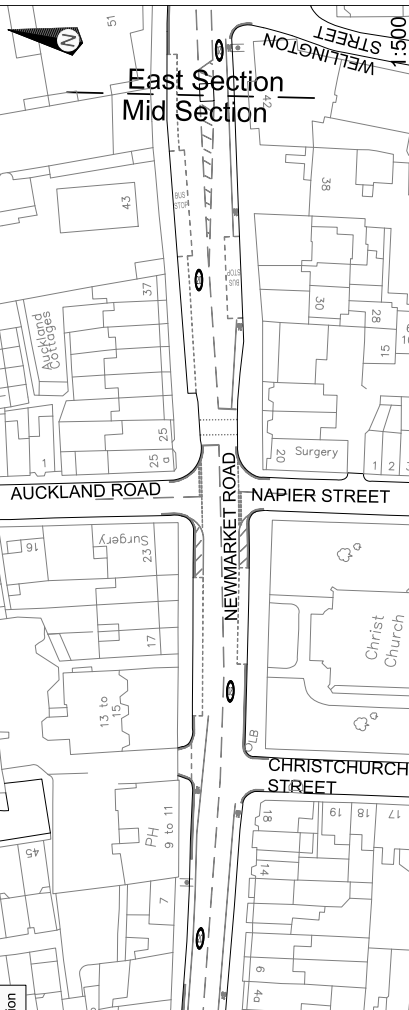
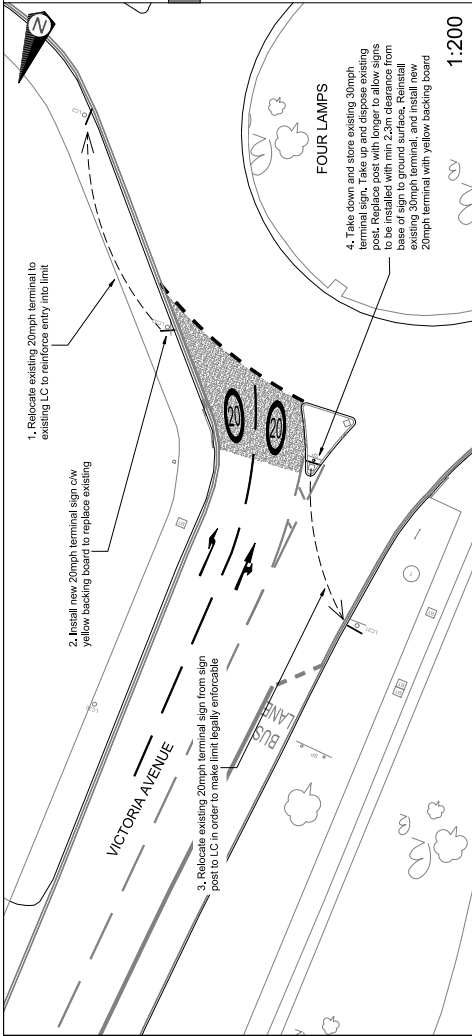
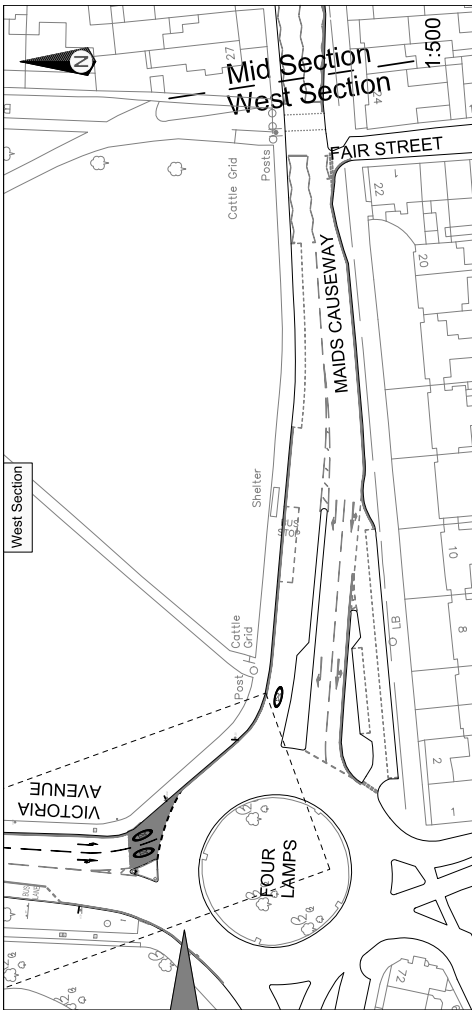

1. Relocate existing 20mph terminal to existing LC to reinforce entry into limit
2. Install new 20mph terminal sign c/w yellow backing board to replace existing
3. Relocate existing 20mph terminal sign from sign post to LC in order to make limit legally enforceable
4. Take down and store existing 30mph terminal sign. Take up and display existing post. Replace post with longer to allow signs to be installed with min 2.3m clearance from base of sign to ground surface. Reinstall existing 20mph terminal sign on existing illuminated post. Relocate existing 20mph terminal with yellow backing board

1. Relocate existing 20mph terminal to back of existing 30mph terminal sign post on north side of Newmarket Road to make entry point legally enforceable
2. Relocate existing lorry ban sign to existing 20mph terminal sign post. Fit new illumination unit to post.
3. Replace lorry ban sign with new 20mph terminal c/w yellow backing board on existing illuminated post
4. Remove existing 20mph terminal sign and move existing CPZ sign down to accommodate lorry ban sign above it
5. Relocate existing lorry ban sign to existing 20mph terminal sign post. Only scale up to 20mph. Do not scale up to 30mph. Such this sign does not require illumination under the current authorisation
6. Replace lorry ban sign with a new 20mph terminal c/w yellow backing board.

KEY

- Proposed new white colour line marking
- Proposed red coloured antislide road surface treatment

ENVIRONMENTAL STATEMENT
 ENVIRONMENTAL PROJECT
 BRIDGE PARK
 DIVISION OF ENVIRONMENTAL
 400 BOX 100, COVENTRY, CV3 9EF
 TEL: 02476 375000 FAX: 02476 375001

Job Title Veris
Scale A1
Drawn By Veris
Checked Veris
Date 15/02/13
Approved Veris
Drawing Title 20mph Line and Sign Improvements
Outline of Proposals
 Drawing No: 00-1M/09/100/00 (Rev. A)
 00/00